

Version 1.1

This Quick Start Guide is intended to help you quickly get your unit unpacked, mounted, and connected. For detailed instructions, see the SATABeast/SASBeast Installation and Maintenance Manual or the Nexsan User Manual.

Taking Delivery

Upon receipt of your SATABeast/SASBeast, inspect the packaging for damage that may have been sustained in transit. If there is visible damage on the packaging, contact your shipper before proceeding.

Unpacking the Unit

Carefully unpack your SATABeast/SASBeast and inspect each item before installation:

1. Carefully cut the straps holding the box closed and remove the outer lid.
2. Remove the disk boxes, the accessory box, the inner rails, the padded envelope, the outer packaging sleeve, and the top foam insert from the outer box.
3. Open the accessory box and padded envelope and make sure that all expected contents are present. The accessory box/padded envelope should contain:
 - rack-mounting hardware: four (4) side rail assemblies, two left and two right; two (2) front mounting brackets, one left and one right; two (2) adjustable rear mounting brackets, one left and one right; twenty (20) mounting rail assembly screws; sixteen (16) screws for securing the assembled rails to the rack; twenty (20) screws for securing the side rails to the chassis; four (4) rack bolts and four (4) cage nuts for securing the SATABeast/SASBeast to the rack
 - other accessories: two (2) power cables; disposable ESD strap; null-modem cable; disk-extraction handle; any additional items that may have been ordered, such as SAS cables or Fibre Channel cables
4. Open the disk boxes and make sure that the proper number of disk drives is included.
5. With the help of a second person, carefully lift the SATABeast/SASBeast unit out of the packaging.

The packaging that the unit ships in is reusable and should be retained for future re-shipment. Be sure to keep all packaging components.

Before You Begin

Required Tools and Equipment

To perform the installation, you will need the following tools and equipment:

- a suitable equipment rack (1,200mm deep recommended) with sufficient load capacity to hold the SATABeast/SASBeast
- a size P1 Phillips-head screwdriver
- enough CAT6 Ethernet cable to connect the SATABeast to the local area network (LAN)
- enough CAT6 Ethernet cable, fibre-optic cable, or twisted-pair copper cable to connect the SATABeast to the storage area network (SAN)

Prepare the Site

Before installing the SATABeast/SASBeast, prepare the installation site and rack. See *Safety Information* for critical site and rack preparation information.

Prepare the Unit

Remove the PSUs and RAID Controllers from the unit:

1. Unscrew the retaining bolt, pull the lever to disengage the PSU, then slide the PSU out of its slot. Be sure to support the PSU's weight while removing it.

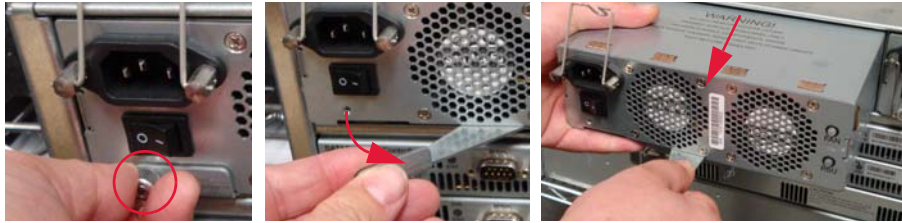

2. Unscrew both retaining bolts and pull both levers to disengage the RAID Controller. Slide the RAID Controller out of its slot. Be sure to support the RAID Controller's weight while removing it.

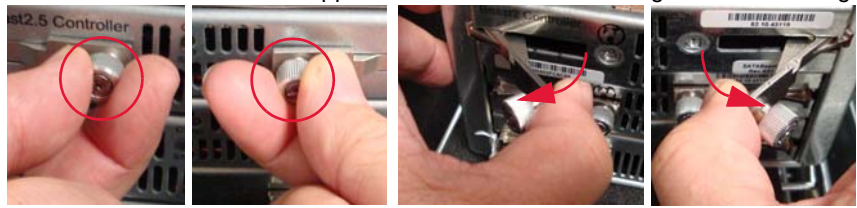

3. Label the controllers "Top" and "Bottom" before setting them aside.

Prepare the Mounting Rails

1. For each side mounting rail assembly, separate the inner and outer rails.



2. Attach the outer rails to the mounting brackets.



3. Loosely attach the rear mounting brackets to the rail assemblies, making sure that the rear bracket can still move freely.



4. Attach each rail to the rack, then insert the cage nuts above and below each rail.

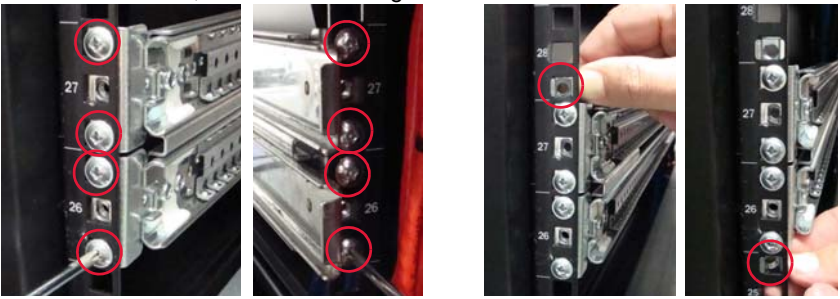

Mount the Unit

1. Attach the inner rails to each side of the chassis. The latch should be closer to the rear of the unit.

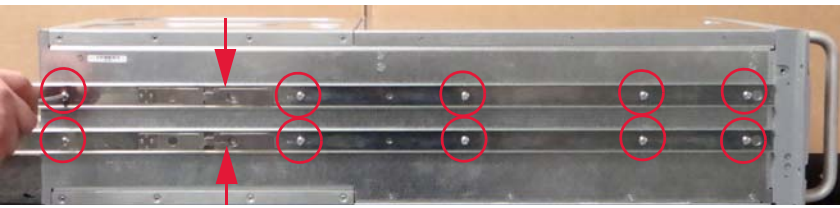

2. With the help of another person, lift the chassis, carefully line up the inner rails with the rack rails, and slide the chassis into the rack.



Restore the Rear Modules

1. RAID Controllers: Slide the RAID Controller into its slot. For the bottom unit, be careful to not snag the cables in the blower unit below.

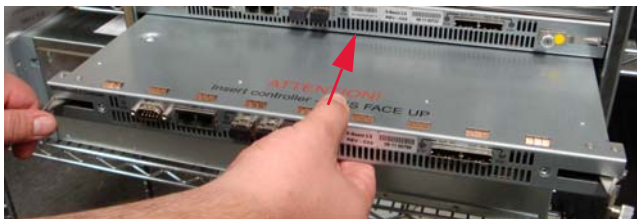

Push in the latch levers to seat it, then tighten the retaining bolts.

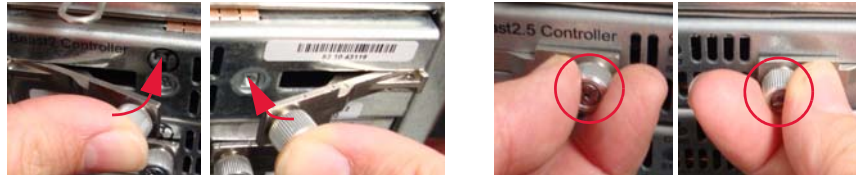

2. PSUs: Slide the PSU into its slot, push the latch handle in to seat it, then tighten the retaining bolt.

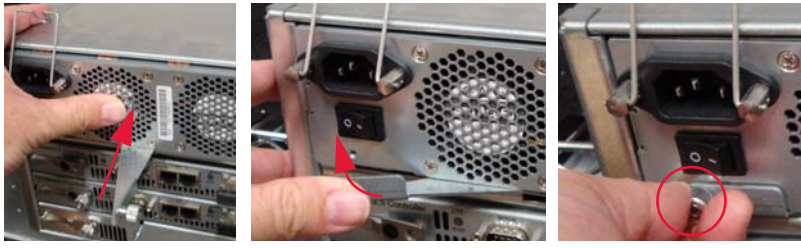

NOTE: Do not connect the power cords to the PSUs at this time.

Load Disk Drives

1. Pull the unit forward until there is enough room to remove the top cover.
2. Unscrew the retaining screws for the front panel (one on each side), then pull the front panel down.



3. Open the drive drawer lid.
4. Starting at the front of the drawer, and using the drive guides to help you orient the disks, carefully load each disk drive into a drive slot. Make sure that each disk is fully seated and that the drive ejection handles are flat against each drive.



CAUTION: Always load disk drives in rows of fourteen. Leaving large gaps between disk drives decreases cooling efficiency and may result in some disk drives overheating.

5. Replace the top cover, close the front face, and replace the front panel retaining screws.
6. Slide the unit back into the rack.
7. Using the supplied bolts, bolt the face of the SATABeast/SASBeast unit to the rack.



Attach Cables

Connect all necessary communication cables (Fibre Channel, Ethernet, expansion, serial) to the appropriate connectors on the RAID Controller. See the *Nexsan SATABeast/SASBeast/SATABeast Xi Installation and Maintenance Manual*.



Apply Power and Turn On

Using the two supplied power cords, connect each PSU to main power, making sure to fold down the retaining clip over each one. Then turn the unit on by switching each PSU's power switch to the on (I) position.





Register and Configure the Unit

The Nexsan Product ID is located on the bottom left of the rear panel. Go to <http://register.nexsan.com> to register your product.

Once the unit has finished booting up, follow the instructions in *Chapter 1, Basic Setup* of the *Nexsan User Manual* to get your SATABeast/SASBeast system up and running.

Safety Information

 **CAUTION:** When removing the SATABeast or SASBeast from the packaging, DO NOT lift the unit by the handles on the front of the chassis. Doing so may cause damage to the chassis or to internal components, or both. Lift the unit ONLY by the bottom edges of the chassis, using safe lifting practices.

 **CAUTION:** Ensure that the ambient temperature at the installation site is between 5°C (41°F) and 35°C (95°F). If the temperature at the site is not actively regulated, ensure that daily and seasonal temperature changes will not result in the ambient temperature going outside these limits.

 **CAUTION:** Always fully stabilize racks with wall anchors or stabilizing legs, or both, before mounting the SATABeast/SASBeast, or any other components on the rack.

 **CAUTION:** Situate the rack so that full air flow at both the front and the rear of the SATABeast/SASBeast is possible.

 **CAUTION:** Ensure that the floor beneath the mounting rack has enough load-bearing capacity to support the rack and all mounted components.

 **CAUTION:** Always fully secure all rack-mounting hardware when installing the SATABeast/SASBeast in a rack. Insufficient rack-mount support may allow the unit to fall onto other rack-mounted hardware or onto the floor, potentially damaging equipment or causing injury to nearby personnel.

 **CAUTION:** When applying power to the SATABeast/SASBeast, use ONLY the IEC power cords originally supplied with the unit. Do NOT use other power cords, even if they appear identical to the supplied cords.

 **CAUTION:** The SATABeast/SASBeast unit is heavy and requires two people to lift it and slide it onto the mounting rails. Do NOT attempt to mount the unit onto the mounting rails by yourself.

 **CAUTION:** Computer components and disk drives are sensitive to electrostatic discharge (ESD). Be sure to ground any electrostatic charge from your person before touching components with your hands or with any tools. While installing the unit, use the anti-static wrist-strap shipped with the unit.

NEXSAN

Part number: P0450055

Release Date: January 2012

Version: 1.1

Technical Support

By Phone:

U.S. & Canada: 866.2.NEXSAN (866-263-9726) or 760.690.1111

Europe, Middle East, Africa: +44 (0) 1332 291600

Japan: +81 3 5449 7590

By Email: support@nexsan.com

By Web: <http://www.nexsan.com/support/service-request.aspx>

Copyright © 2011–2012 Nexsan Corporation. All Rights Reserved. Nexsan®, SATABeast®, SASBeast™, and the Nexsan logo are trademarks or registered trademarks of Nexsan Corporation. All other trademarks and registered trademarks are the property of their respective owners.

NEXSAN 1445 Lawrence Drive, Thousand Oaks, CA 91320 | p. 866.4.NEXSAN | www.nexsan.com